

# **INITIAL RECEIPT**

**United States Department of the Interior**  
**Bureau of Land Management**  
 DIV OF LANDS, MINRLS & ENERGY  
 ONE N CENTRAL AVE  
 PHOENIX, AZ 85004 -4427  
 Phone: 602-417-9200

Receipt	
No:	4838494

<b>Transaction #:</b> 4966571
<b>Date of Transaction:</b> 11/17/2020
<b>CUSTOMER:</b>
MATTHEW LEATHERMAN 14836 W REDFIELD RD SURPRISE, AZ 85379-7434 US

LINE #	QTY	DESCRIPTION	REMARKS	UNIT PRICE	TOTAL
1	1.00	LOCATABLE MINERALS / MINING CLAIMS-NEW, UNADJUD, ONE OR MORE AUTH NOS / NEW MINING CLAIM PROCESSING FEE CASES: AMC461798/\$20.00		- n/a -	20.00
2	1.00	LOCATABLE MINERALS / MINING CLAIMS-NEW, UNADJUD, ONE OR MORE AUTH NOS / NEW MINING CLAIMS LOCATION FEE CASES: AMC461798/\$40.00		- n/a -	40.00
3	1.00	LOCATABLE MINERALS / MINING CLAIMS-NEW, UNADJUD, ONE OR MORE AUTH NOS / NEW MINING CLAIMS MAINTENANCE FEE CASES: AMC461798/\$165.00		- n/a -	165.00
<b>TOTAL:</b>					<b>\$225.00</b>

PAYMENT INFORMATION			
1	AMOUNT:	225.00	POSTMARKED: N/A
	TYPE:	CHECK	RECEIVED: 11/17/2020
	CHECK NO:	111	
	NAME:	MORRISON, TIMOTHY JOHN 31019 N 164TH DR SURPRISE AZ 85387 US	

ENTERED

NOV 23 2020

BY: *ZOC*

REMARKS

This receipt was generated by the automated BLM Collections and Billing System and is a paper representation of a portion of the official electronic record contained therein.

# **CORRESPONDENCE**

# **TRANSFERS**

**MAINTENANCE FEES**  
**WAIVERS**  
**POL/NOI**

# **MISCELLANEOUS**

**LOCATION NOTICES  
AMENDMENTS  
STATUS SHEET  
GEO REPORT/MTP**







LOCATION NOTICE FOR PLACER MINING CLAIM

Amendment BLM Serial # \_\_\_\_\_

NOTICE IS HEREBY GIVEN that the Quail Hill  
placer mining claim has been located by  
Matthew Leatherman

whose current mailing address is:

14836 W Redfield Rd Surprise AZ 85379

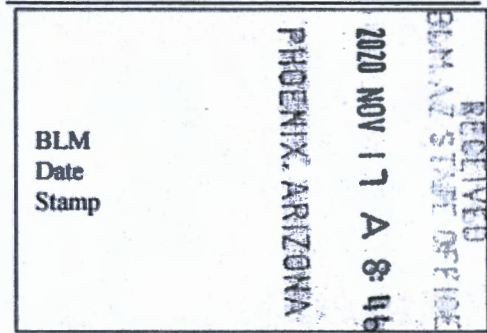

The general course of this claim is **North to South** and it is situated in **Maricopa** County, Arizona. This claim is **1320** feet in length and **660** feet in width.

**20** Total Claim Acreage. This claim runs from the location monument on which this location notice is posted at the **SE** corner of the claim approximately **1320** feet in a **North** direction to the **North** end line and **660** feet in a **West** direction to the **West** end line. This claim is marked by four monuments, one at each corner of the claim. The location monument on which this notice is posted is situated within Section **20**, Township **07N** Range **03W**, Gila Salt River Base and Meridian, Arizona. This claim encompasses portions of the following legal subdivision(s) if located by legal subdivision or the following quarter section(s), section(s), Township(s) and Range(s) **E 1/2 of the NE 1/4 of the NW 1/4 of Section 20 Township 07N Range 03W**, Gila Salt River Base and Meridian, Arizona. The locality of this claim with reference to some natural object or permanent monument and additional information (if any) concerning its locality are as follows: **The NW corner of this claim is located 1920' East of the NW corner of Section 20 Township 07N Range 03W Gila Salt River Base and Meridian, Arizona.**

The above information is shown on the attached map. DATED AND POSTED on the ground this 19 day of September 20 20.

Claimants:

Printed Name Matthew Leatherman Signature(s) [Signature]

address: 14836 W Redfield Rd Surprise AZ 85379

Printed Name \_\_\_\_\_ Signature(s) \_\_\_\_\_

address: \_\_\_\_\_

AMC461798

MINING CLAIM MAP

Lode ( ) Placer ( )  
Millsite ( )

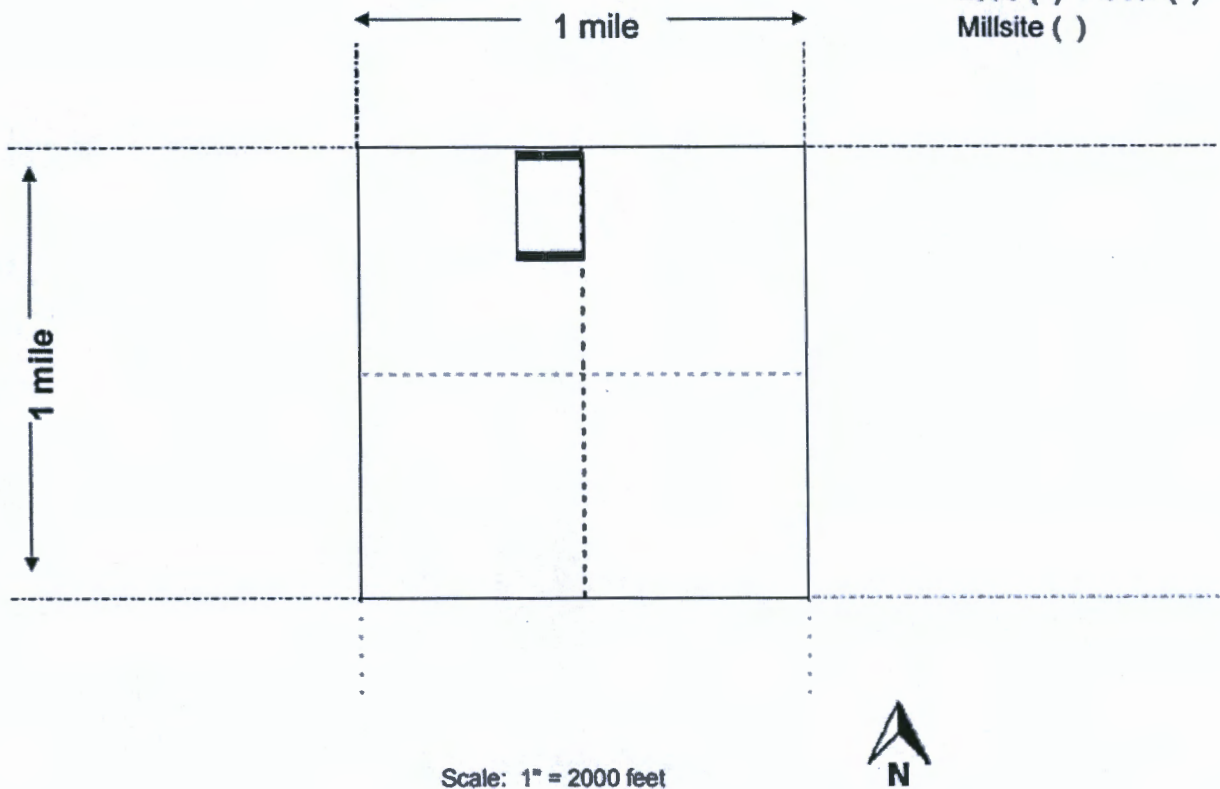

1. The above map depicts the Quail Hill mining claim, which is located in Section 20, Township 07N, Range 03W, Gila and Salt River Base and Meridian, Maricopa County, Arizona.

Total claim acreage is 20.

2. The type of corner and location monuments used are as follows: 4' capped PVC

3. The bearings and distances in degrees and feet between claim corners and to a public land survey monument are as depicted on the map. The NW corner of this claim is located 1980ft

East of the NW corner of Section 20 Township 07N Range 03W Gila Salt River Base and Meridian, Arizona.

4. If the claim is a placer or millsite claim with exterior limits conforming to legal subdivisions of the public survey, provide a legal description of the claim E 1/2 of the NE 1/4 of the NW 1/4 of Section 20 Township 07N Range 03W, Gila Salt River Base and Meridian, Arizona.

This form is available from the Arizona Geology Survey and may be reproduced.

RECEIVED  
BLM AND STAFF OFFICE  
2020 NOV 17 A 8:46  
PHOENIX, ARIZONA

AMC461798

DEPARTMENT OF THE INTERIOR  
BUREAU OF LAND MANAGEMENT  
Case Recordation

Geographic Report with Land

Disposition is equal to **AUTHORIZED , CANCELLED , EXPIRED , PENDING , REJECTED , RELINQUISHED ,  
WITHDRAWN**

**and** Meridian Township Range Section is equal to **14 0070N 0030W 020**

**and** Admin State is equal to **AZ**



DEPARTMENT OF THE INTERIOR  
BUREAU OF LAND MANAGEMENT  
Case Recordation  
Geographic Report with Land

Admin State: AZ  
Geo State: AZ  
Serial Number: AZA 031514

Total Case Acres: 1.000

Casetype	Case Disp	Mer	Twp	Rng	Sec	Sur Type	Sur Nr	Suf	Subdivision	Pending Action
380913	PENDING	14	0070N	0030W	020	ALIQ			NENW;	

Admin State: AZ  
Geo State: AZ  
Serial Number: AZA 031568

Total Case Acres: 1.000

Casetype	Case Disp	Mer	Twp	Rng	Sec	Sur Type	Sur Nr	Suf	Subdivision	Pending Action
293200	EXPIRED	14	0070N	0030W	020	FF			PORTION OF;	

Admin State: AZ  
Geo State: AZ  
Serial Number: AZA 031961

Total Case Acres: 1.000

Casetype	Case Disp	Mer	Twp	Rng	Sec	Sur Type	Sur Nr	Suf	Subdivision	Pending Action
293200	EXPIRED	14	0070N	0030W	020	FF			PORTION OF;	

Admin State: AZ  
Geo State: AZ  
Serial Number: AZA 032341

Total Case Acres: 1.000

Casetype	Case Disp	Mer	Twp	Rng	Sec	Sur Type	Sur Nr	Suf	Subdivision	Pending Action
293200	EXPIRED	14	0070N	0030W	020	FF			PORTION OF;	

Admin State: AZ  
Geo State: AZ  
Serial Number: AZA 035151

Total Case Acres: 1.000

Casetype	Case Disp	Mer	Twp	Rng	Sec	Sur Type	Sur Nr	Suf	Subdivision	Pending Action
293200	PENDING	14	0070N	0030W	020	FF			PORTION OF;	





Matt Leatherman  
14836 W Redfield Rd  
Surprise AZ 85379

PHOENIX AZ 852  
12 NOV 2020 PM 5 L



Arizona State Office  
One North Central Ave.  
Suite 800 (8th Floor)  
Phoenix, AZ 85004-4427

RECEIVED  
AZ STATE OFFICE  
2020 NOV 17 A 8:46  
PHOENIX, ARIZONA

85004-441499

